

April 29, 2021

To: Jen Hager & The Planning Board

Re: Mickey's Car Wash - Border Fence & Plants

We are requesting that the board will consider allowing Mickey's Car Wash to replace the PVC Fence for 120' along the South border and 8 Junipers, also along the South border with a plan that we feel is more conducive to this project by using natural plants, creating energy flow, adding visual interest to the plaza and demised premises and removing the closed in feeling of a plastic wall barrier.

The approved plan is:

- 120' PVC Fence from the front of the building along the South side to the water drainage area
- 8 Junipers starting after the water drainage area, running along the South side and stopping at the dumpster enclosure.

We are proposing to (See attached photos):

- Replace the 120' PVC fence with:
  - **18 Cherry Laurel Hedges** to grow 6-8' high & 4-6' wide
    - Evergreen
    - Fast growing
  - **18 Weigela Sonic Bloom Pink** in front of Laurel to grow 4-5' high & wide.
    - Stunning color 6 months of the year
    - Blooms in May with waves of blooms until frost
    - Deciduous
    - Attracts butterflies & Hummingbirds
- Replace the 8 Junipers with:
  - **10 Old Fashion Snowball Bush Viburnum**
    - Year-Round Interest
      - Spring Bloom several weeks of snowballs & bright green foliage
      - Fall leaves are bright burgundy with red berries
      - Winter red berries attract birds
      - Deciduous but retains small flowers



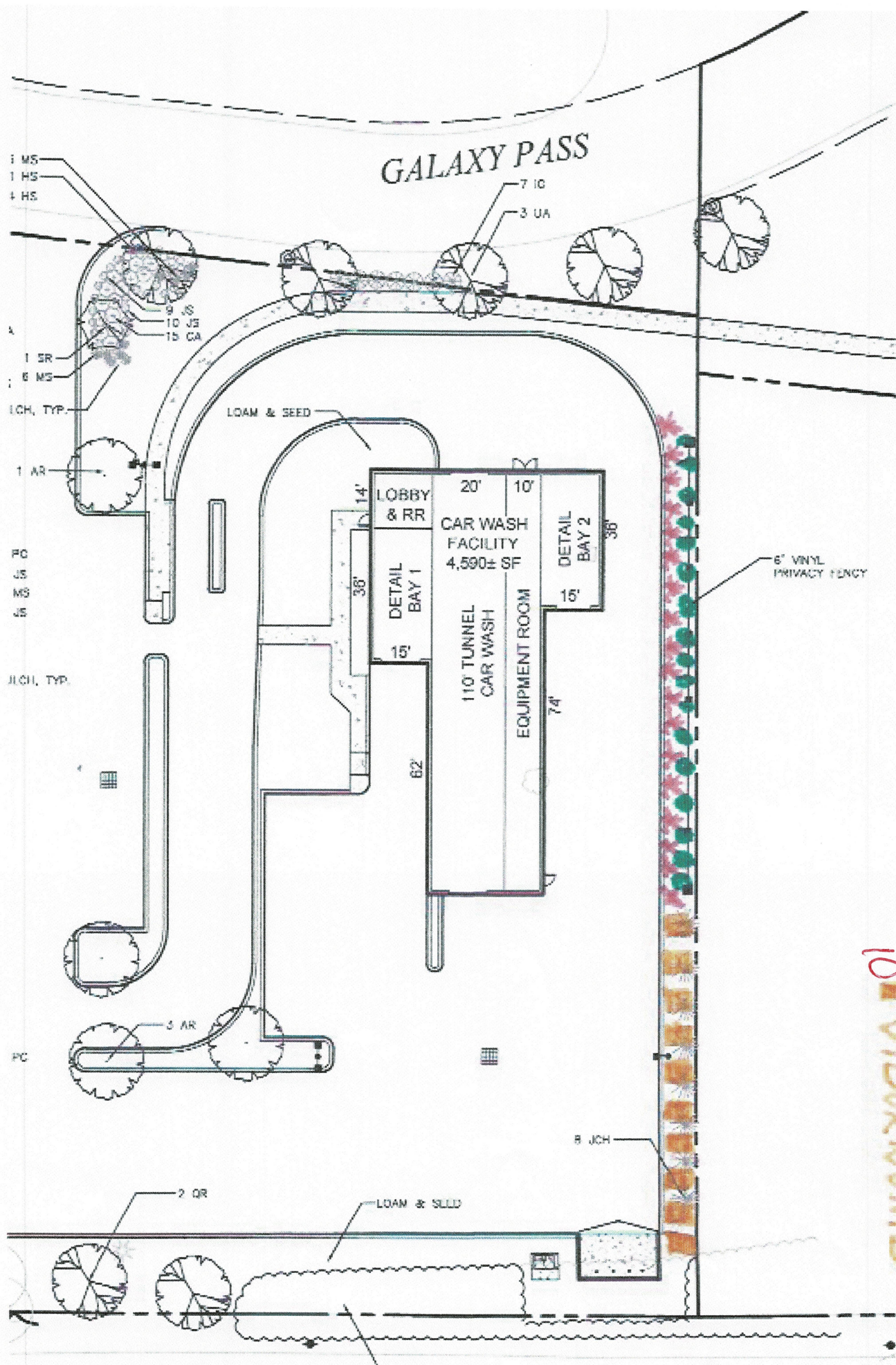

18 • LAUREL 3'  
18X WEIGER 3'  
10 VIBURNUM 3'