



Town of Sutton
Planning Department
4 Uxbridge Road
Sutton, Massachusetts 01590
508-865-8729
<https://www.suttonma.org/planning-board>

**APPLICATION FOR SCENIC ROAD ALTERATION (MGL c. 40 §15C)
& APPLICATION FOR PUBLIC SHADE TREE (MGL. c. 87 §3) (when applicable)**

APPLICANT & PROPERTY OWNER INFORMATION

NAME UGPG RE SUTTON LLC
STREET 223 Worcester Providence Turnpike CITY/TOWN Sutton
STATE MA ZIP 01590 PHONE 508-865-1155 EMAIL art.mahassel@ugpg2.com

NAME, ADDRESS & CONTACT INFO OF PROPERTY OWNER (if different from Applicant)

SITE INFORMATION:

40 and 42 Unified Parkway, formerly known as:
STREET AND NUMBER 105 Providence Road

ASSESSOR'S MAP 6 LOT #(S) 25 DEED INFO BOOK 63692 PAGE 50

PROJECT INFORMATION:

PROVIDE THE FOLLOWING INFO:

- | | |
|---|---|
| <input checked="" type="checkbox"/> Alteration to stone wall | <input checked="" type="checkbox"/> Picture of walls and/or trees to be altered |
| <input checked="" type="checkbox"/> Alteration to public shade tree | <input checked="" type="checkbox"/> Map of location of wall alterations with dimensions |
| | <input checked="" type="checkbox"/> Map of location of trees to be altered with dbh size |
| | <input checked="" type="checkbox"/> Sketch/photo of proposed type/style of wall alterations |

PROJECT DESCRIPTION (add additional page if needed): Alteration of intersection of Boston Road and Unified Parkway, a
a new subdivision roadway approved pursuant to Certificate of Approval of Definitive Subdivision Plan dated January 12, 2022, as
part of the development of Lots 2 and 3 shown on such subdivision plan. See definitive subdivision plan modification request
submitted concurrently with this application.

APPLICANT'S SIGNATURE *Arthur Mahassel* DATE 9/26/22
PROPERTY OWNER'S SIGNATURE (if not Applicant) _____ DATE _____

Boston Road
Facing Westbound

Photo No. 1A

Maintain Existing 68-Inch Sycamore Tree
and Remove Invasive Knot Weed Around
the Base of Tree

Maintain Existing Stone Wall

Application for Alteration of Scenic Roadway & Application for Public Shade Tree

UGPG RE Sutton LLC
Boston Road Improvements at Proposed Unified Parkway - Southerly Widening

Boston Road
Facing Eastbound

Photo No. 1B

Approximate Area of Widening

Application for Alteration of Scenic Roadway & Application for Public Shade Tree

UGPG RE Sutton LLC
Boston Road Improvements at Proposed Unified Parkway - Southerly Widening



Approximate Area of Widening
Utility Pole to Remain



107 Boston Road Driveway To Be Regraded

Approximate Limits of Roadway
Widening and Retaining Wall Required

Application for Alteration of Scenic Roadway & Application for Public Shade Tree

UGPG RE Sutton LLC
Boston Road Improvements at Proposed Unified Parkway - Southerly Widening

Boston Road
Facing South

Photo No. 4

107 Boston Road

Approximate Retaining Wall
Location and Height

Approximate Area of
Roadway Widening

Application for Alteration of Scenic Roadway & Application for Public Shade Tree

UGPG RE Sutton LLC
Boston Road Improvements at Proposed Unified Parkway - Southerly Widening

Boston Road
Facing Eastbound

Photo No. 5

Approximate Boston Road R.O.W.
(yellow line)

Approximate Limits of Roadway
Widening and Retaining Wall Required

Application for Alteration of Scenic Roadway & Application for Public Shade Tree

UGPG RE Sutton LLC
Boston Road Improvements at Proposed Unified Parkway - Southerly Widening



Approximate Boston Road R.O.W.
(yellow line)

Approximate Limits of Roadway
Widening and Retaining Wall Required

Application for Alteration of Scenic Roadway & Application for Public Shade Tree

UGPG RE Sutton LLC
Boston Road Improvements at Proposed Unified Parkway - Southerly Widening



Boston Road
Facing Eastbound

Photo No. 7



Approximate Limits of Roadway Widening

Application for Alteration of Scenic Roadway & Application for Public Shade Tree

UGPG RE Sutton LLC
Boston Road Improvements at Proposed Unified Parkway - Southerly Widening

Boston Road
Facing South

Photo No. 8



Existing Trees To Be Removed
To Allow For Retaining Wall
And Off Grading

Application for Alteration of Scenic Roadway & Application for Public Shade Tree
UGPG RE Sutton LLC
Boston Road Improvements at Proposed Unified Parkway - Southerly Widening

Boston Road
Facing Eastbound

Photo No. 9

Limited Tree Removal Required for
Sidewalk Construction & Off Grading

Approximate width of Limited
Roadway Widening & Sidewalk

Application for Alteration of Scenic Roadway & Application for Public Shade Tree

UGPG RE Sutton LLC
Boston Road Improvements at Proposed Unified Parkway





Limited Tree Removal Required
For Sidewalk Construction

Approximate Width For Limited
Roadway Widening & Sidewalk
& Off Grading (Width Varies)

Application for Alteration of Scenic Roadway & Application for Public Shade Tree

UGPG RE Sutton LLC
Boston Road Improvements at Proposed Unified Parkway

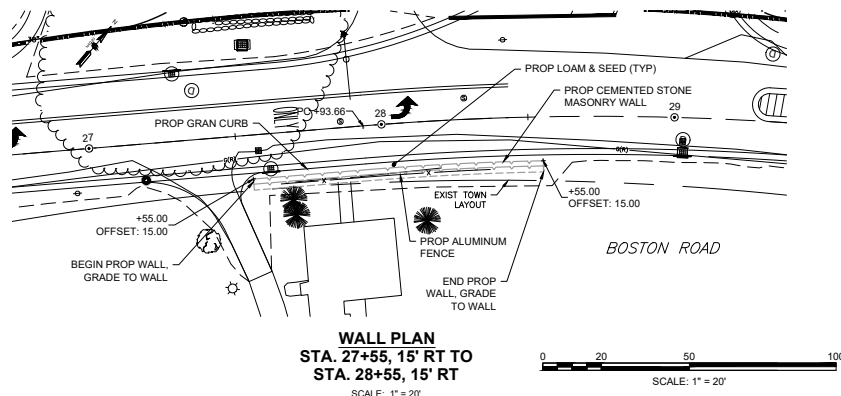

FACE

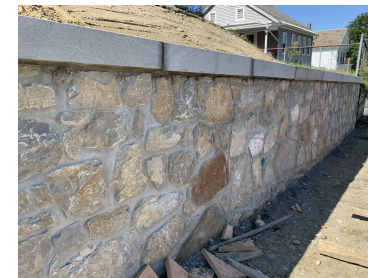

ISOMETRIC FACE

FINISHED WALL
SCALE: NONE
(STOCK IMAGE FOR GENERAL
REFERENCE PURPOSES ONLY)

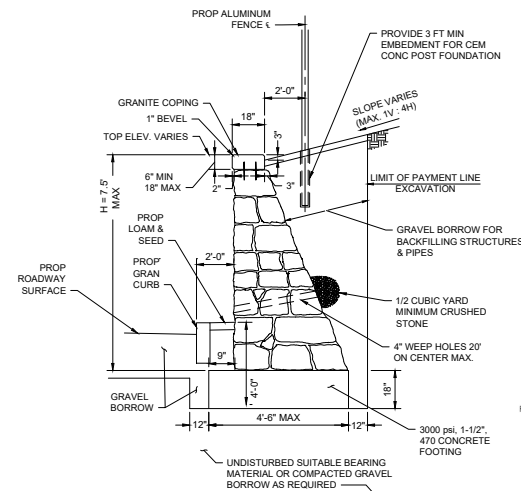
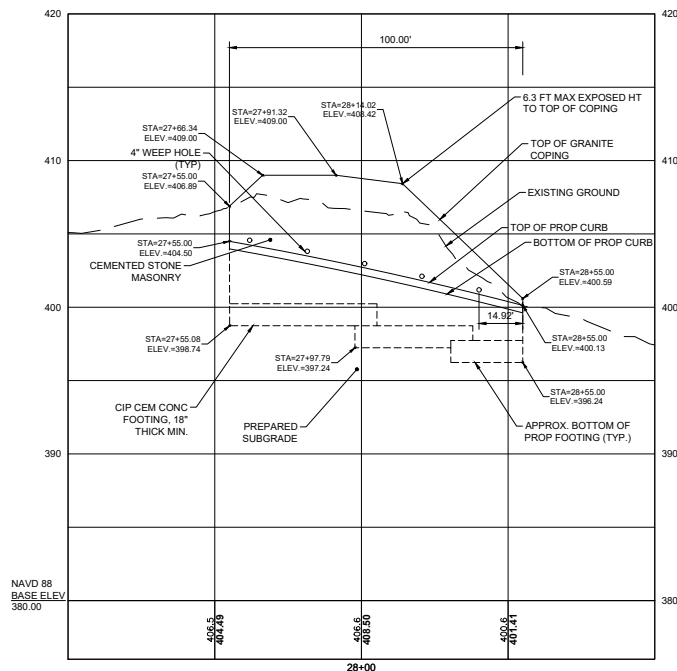

CEMENTED STONE MASONRY - WALL SECTION
SCALE: N.T.S. DWG: SP-01 DATE: APRIL 2013

- WALL SECTION NOTES:
1. SEE CONSTRUCTION STANDARDS PLATE 302.2.0 FOR ADDITIONAL DETAILS.
2. FOR WALL JOINT DETAILS SEE THIS SHEET.